



SIGNATURE HOMES
— RESIDENTIAL LEASING —



Dynasty Court

23 Old Peak Road, Mid-Levels, Hong Kong

Situated in Hong Kong's popular and prestigious Mid-Levels area, Dynasty Court offers a brilliant location with spectacular city scenery and unobstructed harbour views.

- ♦ A 20,000 sf. comprehensive clubhouse that suits all family members with a wide range of amenities
 - ♦ 3 to 4-bedroom apartments have been designed to provide optimum space and comfort
- ♦ Ideally located in a neighborhood with easy access to shops, top schools, and recreation areas such as Hong Kong Zoological and Botanical Gardens
 - ♦ Launched a brand new design for Tower 2





VR 360

BRAND NEW DESIGN FOR TOWER 2



Flat A



Flat B

Top highlights of the new design:

- ◆ Entirely refurbished lobby and introducing a brand new design for our apartments.
- ◆ Fully upgraded air-conditioning system, giving a sense of higher headroom teamed along with our new stylish flooring for durability and easy maintenance.
- ◆ Reconfigured modern kitchen design and layout with spacious storage and utility area.
- ◆ Upgraded with reputable kitchen appliances with a built-in oven, electronic wine cellar, refrigerator, and dishwasher.
- ◆ The newly designed master bedroom is furnished with built-in closets, auto lighting function while opening and larger storage space.
- ◆ The Master bathroom is designed with new floor-to-ceiling windows and sliding doors for separate shower and bathtub areas while maintaining the natural lights along with our newly upgraded bathroom sanitary wares.



FEATURES

- ◆ Facilities within Dynasty Club include two outdoor swimming pools (include one heated pool), tennis court, gymnasium, children's playground, function room with banquet facilities, onsite restaurant and more
- ◆ Spacious kitchen includes modern cabinets, built-in oven and other appliances
- ◆ Regular shuttle bus with easy access to Central and Admiralty



FLOOR PLAN

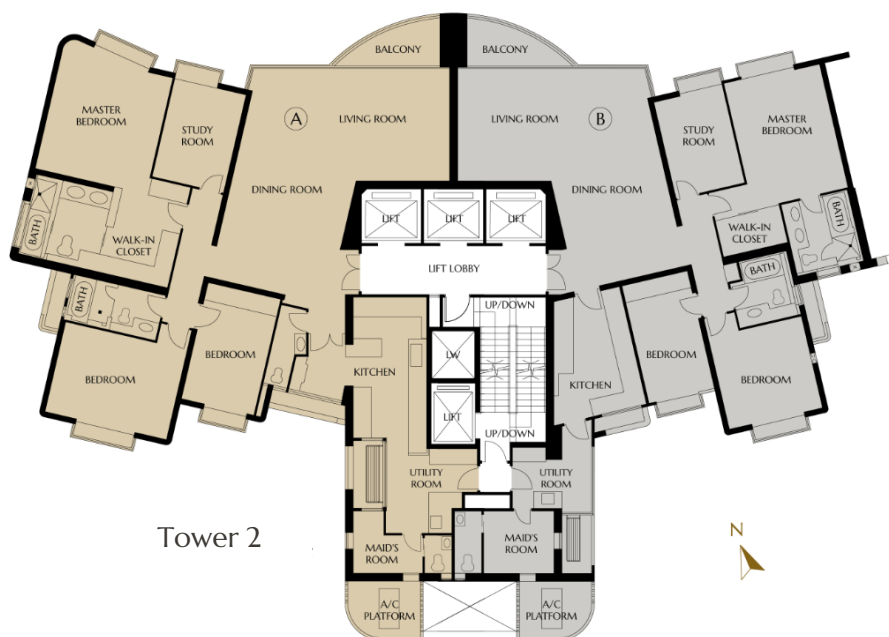

Tower 2



Gross Area: 2,256 sf. – 2,691 sf.
Saleable Area: 1,837 sf. – 2,197 sf.



Tower 3



Gross Area: 1,962 sf. – 1,981 sf.
Saleable Area: 1,548 sf. – 1,564 sf.



Leasing & other Enquiries :
+852 2828 7728 / +852 9228 2931 (Mobile / WhatsApp / WeChat)

[signaturehomes.hk](https://www.signaturehomes.hk) www.signaturehomes.hk

The particulars, photos, perspectives, design, finishes and materials, layout size of any part(s) in the brochure are for reference only. No representation made or responsibility accepted for the accuracy of the whole or any part(s). All plans and finishes contained are subject to alterations without prior notice. Please contact us for more information. Licence No. C-073185



新鴻基地產
Sun Hung Kai Properties